

# **ATTACHMENT A**

**Parkside-Lancaster Redevelopment Area Plan**

Philadelphia City Planning Commission  
April 1997

Parkside-Lancaster Redevelopment Area Plan

April 1997

I. Introduction

The Parkside-Lancaster Redevelopment Area is a 230-acre section of West Philadelphia, adjacent to Fairmount Park. The precise boundary is shown on page 3: Parkside Avenue, the SEPTA R-6 right-of-way, 52nd Street, Lancaster Avenue, Girard Avenue, and Belmont Avenue. Properties on both sides of Lancaster Avenue, the 4700 block of Girard Avenue and Belmont Avenue are included in the redevelopment area.

The Parkside-Lancaster Redevelopment Area has been created to facilitate property rehabilitation and redevelopment in the West Parkside neighborhood of West Philadelphia. The major impetus is a proposal from the Parkside Association of Philadelphia in conjunction with Community Ventures for rehabilitation of scattered vacant houses in the neighborhood. The Parkside Association of Philadelphia is the community group of long standing representing the citizens of West Parkside. The rehabilitation proposal is supported by the Office of Housing and Community Development.

The redevelopment area includes several distinct sub-areas. First is the neighborhood of West Parkside. This is a compact residential area situated on either side of 52nd Street (north of the R-5 rail line) and bordered by industrial areas, railroads and Fairmount Park. Approximately 2,000 persons live in West Parkside. Most of the approximately 550 homes in West Parkside are two story row homes, well suited for single family use. The homeownership rate, estimated from census data to be 55%, is a strength of the area. Housing rehabilitation, site improvement and home improvement loan programs were targeted to this neighborhood at different times during the 1970s and 1980s. Because of the high homeownership and previous public investment, and also due the successful efforts of the local community group, there are several blocks which are in good condition -- showing clear signs of homeowner upkeep and improvements to the streetscape. However, there are also a few residential blocks that appear to be in decline.



A second section of the redevelopment area is the Parkside Industrial Park. This is a 60-acre property, entered from the intersection of 49th & Parkside, that had been a large rail yard for the Pennsylvania and Penn Central Railroads. Three companies have constructed new buildings in the industrial park, and some 40 acres of vacant land are available for additional development. The Parkside Industrial Park is owned by Philadelphia Industrial Development Corporation (PIDC). The industrial park is part of the larger Parkside industrial area which includes many older industrial and commercial properties along Merion, Lancaster, Belmont and Parkside Avenues.

Another portion of the redevelopment area is an edge of the Cathedral Park neighborhood -- the properties on the south side of Lancaster Avenue between Girard Avenue and 52nd Street. These properties are a mixture of storefronts, mixed commercial and residential buildings, row housing and a few large commercial uses. This is where the Cathedral Park neighborhood, located to the south and west, begins to interface with the Parkside industrial area.

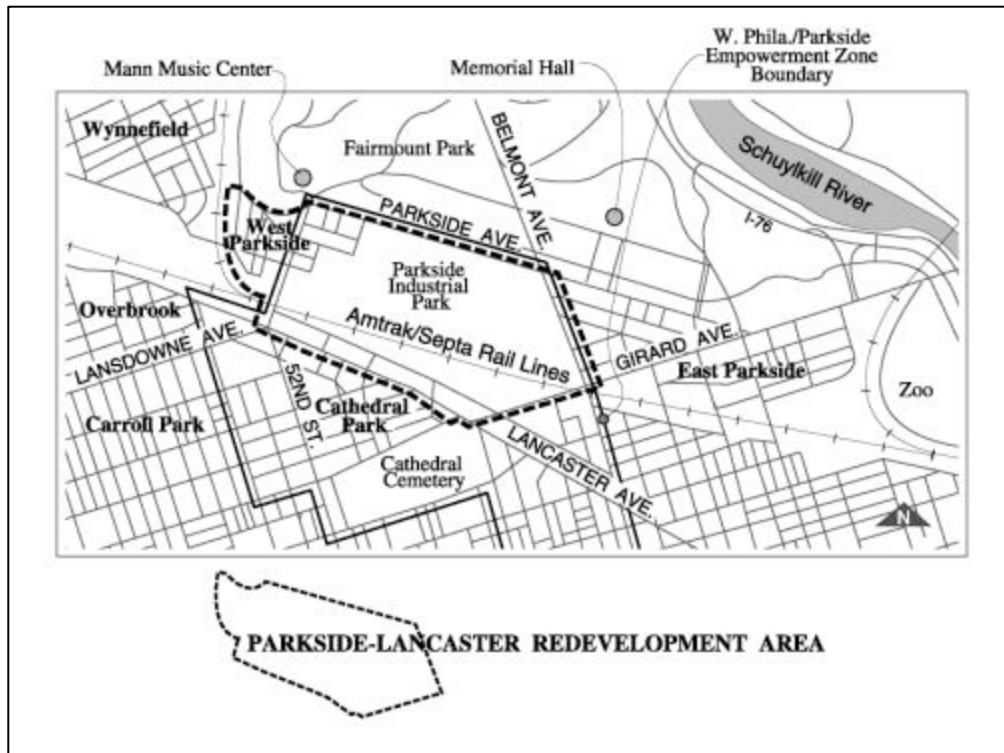

Similarly, the properties on the east side of Belmont Avenue constitute an edge of the East Parkside neighborhood. East Parkside is listed as an historic district on the National Register of Historic Places. This portion of the neighborhood contains commercial properties, a school and fire station, and a few homes.

Most of the Parkside-Lancaster Redevelopment Area is within the Philadelphia/Parkside Empowerment Zone and the West Parkside Enterprise Zone.

There are challenging problems in the neighborhood that need to be addressed. Vacant houses are scattered throughout the area, tax delinquency is at a high level, and the estimated 70-year-old housing stock is increasingly difficult to maintain. Vacancy and physical deterioration are concentrated along the major streets, many older industrial and commercial properties are vacant or

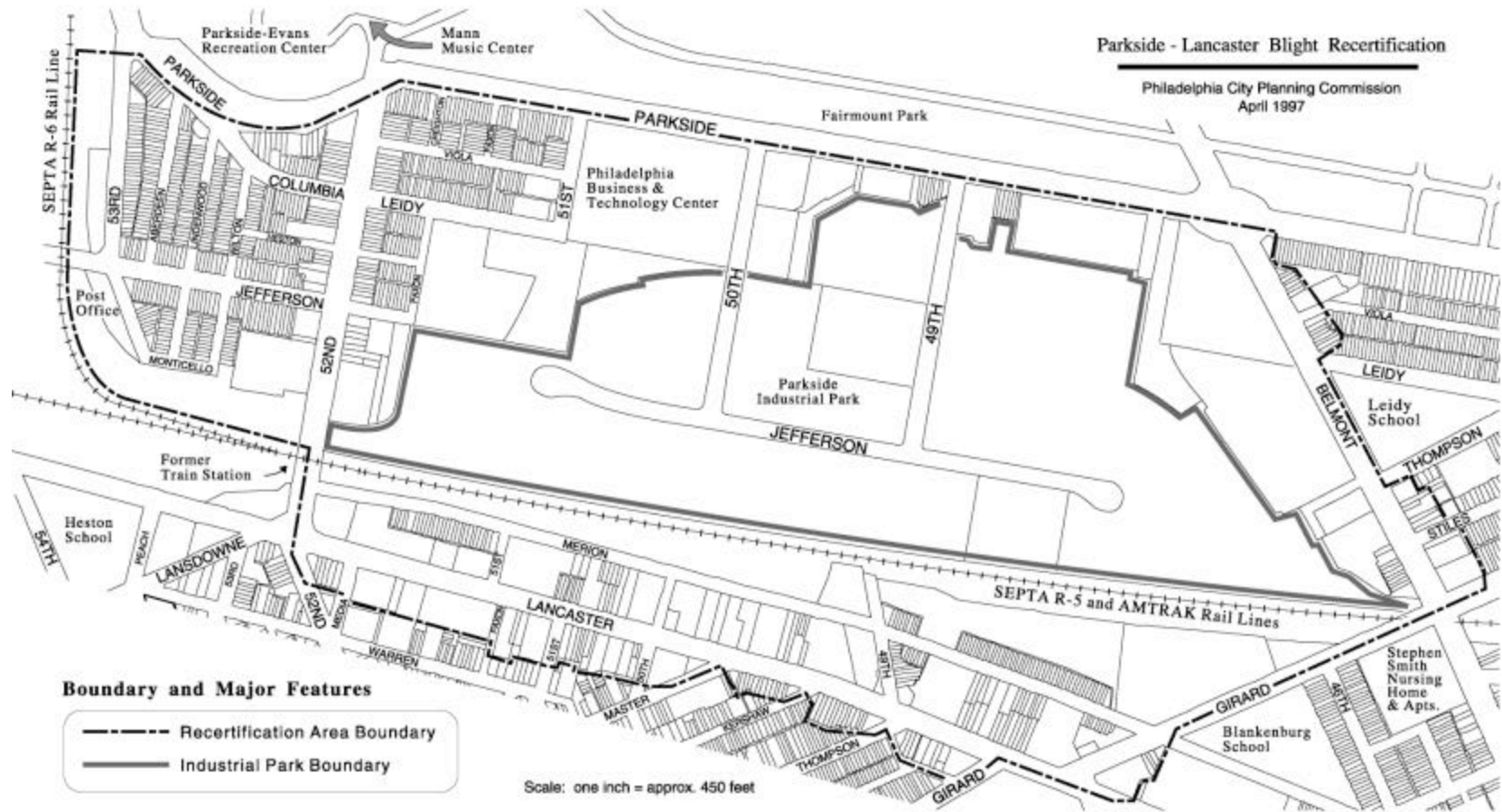

underutilized, and an abandoned train station (elevated) is a noticeable blight near the heavily-traveled intersection of 52nd & Lancaster.

Despite the problems, this area has important advantages as it strives to remain a desirable place to live and work: it is adjacent to Fairmount Park and the Mann Music Center, it has good highway access and bus/trolley service, it contains land and buildings which are a major resource for economic expansion and growth, and it is part of the Empowerment Zone and Enterprise Zone (which provide incentives for economic and community development). This Redevelopment Area designation will provide another tool and yet another advantage, facilitating the stabilization and revitalization of the area.

This Redevelopment Area Plan contains reuse proposals that are intended to maintain the quality and character of the community and rehabilitate the housing while adding some new residential, mixed-use and commercial uses at appropriate locations. These proposals are in accordance with The Plan for West Philadelphia and the City's Comprehensive Plan.

## II. Objectives

The general goal of the West Parkside Redevelopment Area Plan is to provide a framework for present and future redevelopment proposals. Clear planning policies for land use, zoning and capital program investment will permit the full potential of the study area to be realized.

The plan has three specific objectives:

- (1) to encourage rehabilitation of vacant homes,
- (2) to eliminate the blighting influence of undesirable land uses by encouraging the redevelopment of vacant land and buildings, and underutilized properties, and
- (3) to replace substandard or economically obsolete buildings with new construction where rehabilitation is impractical.

## III. Existing Conditions

The subject properties were recertified as blighted on April 17, 1997 by the Philadelphia City Planning Commission. Designation for redevelopment is warranted by the following criteria having been satisfied:

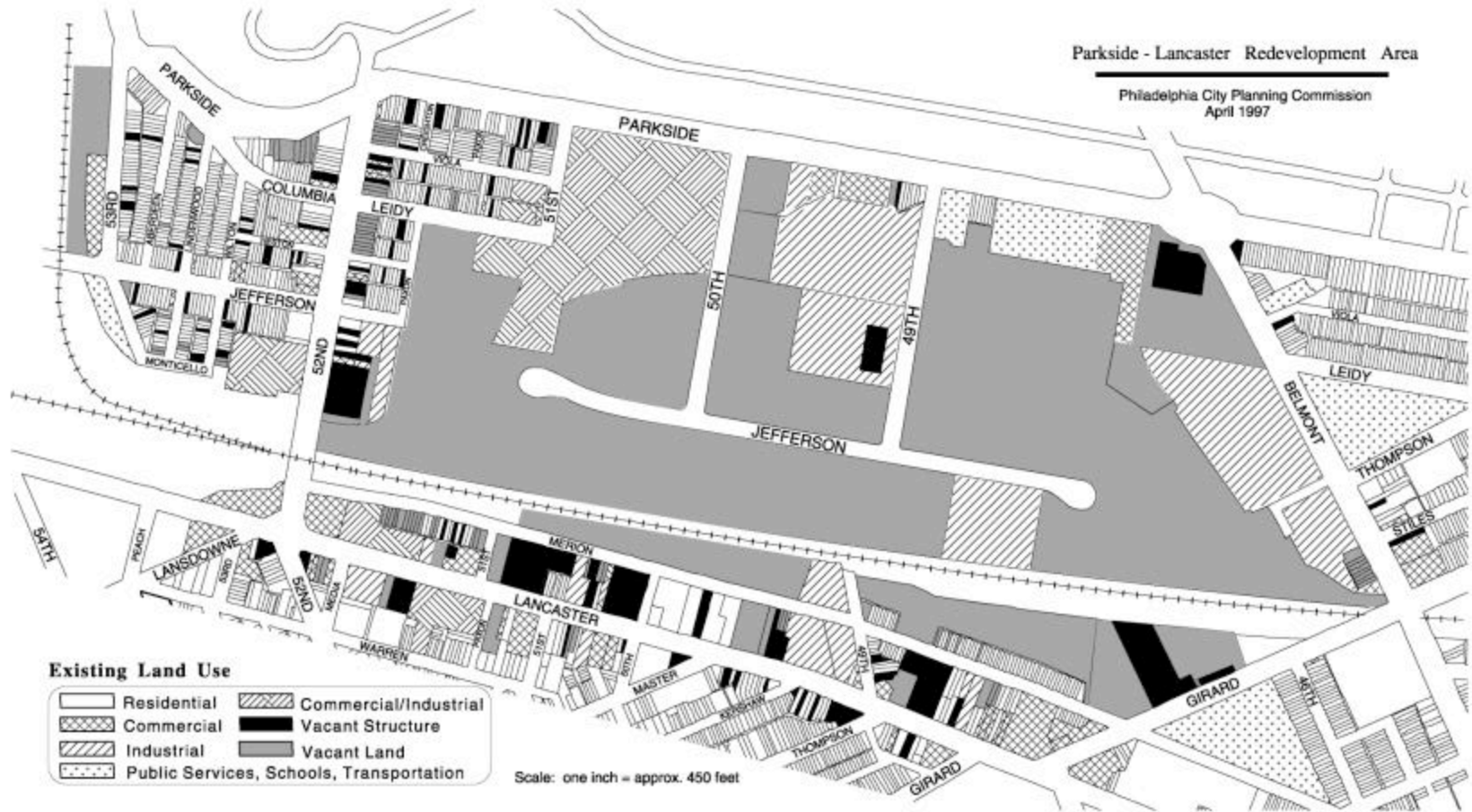

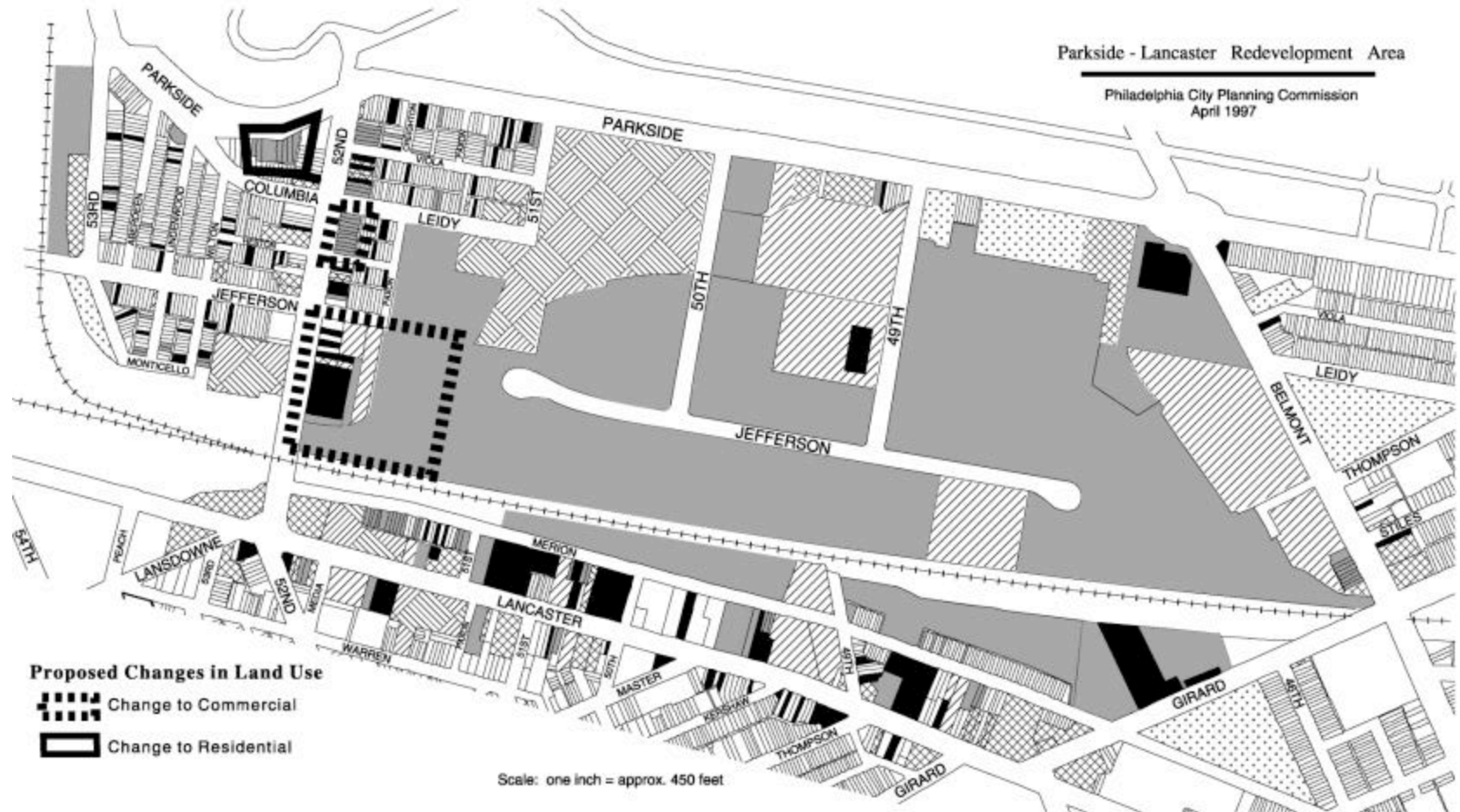



- Unsafe, unsanitary, inadequate conditions.
- Economically undesirable land use.

These conditions have a deteriorating effect on the neighborhood.

Of the 958 properties in the study area, 209 are vacant, and vacancy is concentrated on the main streets: 52nd Street and Lancaster Avenue. Many properties have unsafe and unsanitary conditions which are representative of economically undesirable land use. Tax delinquency is pervasive (38% of privately-owned properties are two or more years tax delinquent). Property values are low: the value of West Parkside's single family homes is about half of the city-wide median value.

#### IV. Existing Land Use

Industrial use and vacant land are predominant land uses because of the large amount of industrial property that is available for future development. The land use along the Lancaster, Girard and Belmont Avenue boundaries is a combination of housing, stores and industrial property.

Within the West Parkside neighborhood, the predominant land use is residential. Fifty-second Street has a different land use pattern, where most of the properties are mixed use or vacant. Parking lots are located on the west side of 51st Street south of Viola Street; these lots are used by employees who work in the Philadelphia Business and Technology Center on the opposite side of 51st Street. Vacant property is widely scattered along most of the streets in the redevelopment area, but vacant land use accounts for more than half of the properties located along the east side of 52nd Street. On the Existing Land Use map, some of the vacant properties in West Parkside are actually gardens or landscaped yards. Therefore in this portrayal of West Parkside's existing land use, the "Vacant" category includes land that is undeveloped and land where open space improvements are considered an interim use until more substantial development can be realized.

#### V. Proposed Land Use

The "Proposed Changes in Land Use" plan is designed to facilitate housing rehabilitation, while also laying the groundwork for appropriate treatment of the major opportunity sites.

*Philadelphia City Planning Commission*

The plan anticipates that many of the vacant homes scattered throughout the neighborhood will be rehabilitated and brought back into productive residential use.

Along 52nd Street, mixed-use commercial/residential development is proposed. A large vacant lot, on the east side of 52nd Street between Columbia Avenue and Heston Street (1621-39 N. 52nd Street), is proposed for new construction of a mixed use building and/or parking. Vacant buildings on 52nd Street north of Jefferson Street are supported for commercial/residential rehabilitation or redevelopment.

On the east side of 52nd Street, from Jefferson Street to the railroad overpass, properties are proposed to be consolidated and redeveloped for retail commercial use. This site (1573-97 N. 52nd Street and 5166 Jefferson Street) is currently occupied by a vacant post office, vacant commercial and residential buildings, vacant land, and several occupied properties used for housing, commercial and industrial purposes. Existing zoning is C-2 Commercial and R-9 Residential. It is possible that the future retail commercial project will occupy a larger site, extending to the south and east into industrial park property that is currently vacant and zoned L-3 Industrial and G-2 Industrial.

The cluster of vacant lots on the south side of Parkside Avenue between 52nd Street and Columbia Avenue (5216-30 Parkside Avenue) is recommended for new residential development, preferably for senior citizens.

The proposed land use categories include the following provisions:

- Mixed commercial/residential use shall be permitted under the Commercial land use category.
- New community centers and educational centers shall be permitted under the Residential and Commercial land use categories.
- New parking lots as a primary use shall be permitted in the Commercial land use category, provided that the parking lots are well landscaped.

#### VI. Illustrative Site Plan

The Illustrative Site Plan depicts the rehabilitation of scattered vacant houses, the construction of a mixed-use building and/or parking at 1621-39 North 52nd Street, the construction of a residential building(s) at 5216-30 Parkside Avenue, and the creation of new retail commercial facilities at 1573-97 N. 52nd Street.

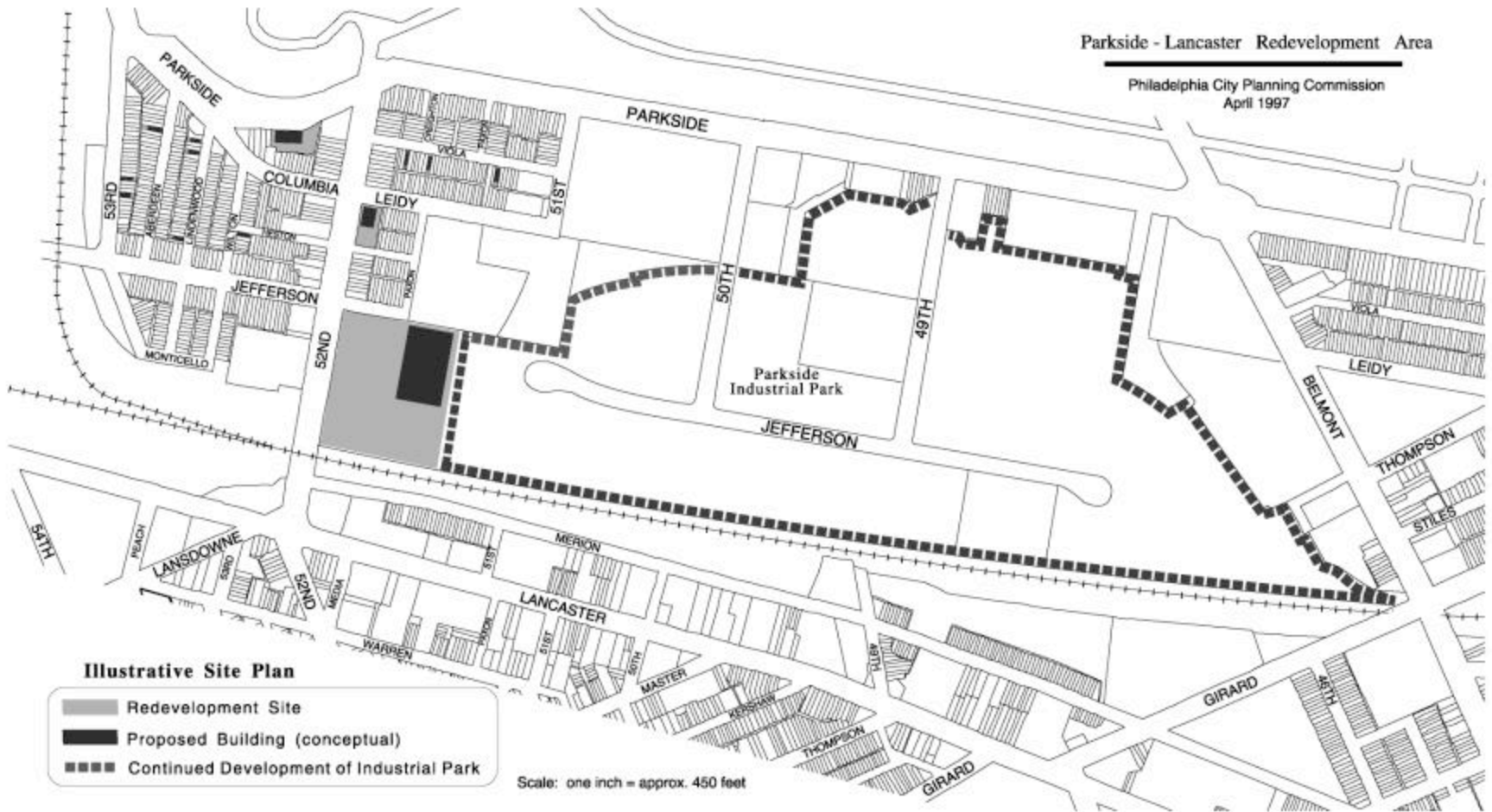

Industrial land will remain an important feature of this area. The Parkside Industrial Park is already owned by a public agency, PIDC, which develops industrial parks in a planned fashion. It is expected that the Parkside Industrial Park will continue to develop, adding jobs and businesses that will benefit adjacent neighborhoods and the City as a whole.

Although not shown on the Illustrative Site Plan, site improvements are recommended in the future as the various redevelopment projects are implemented. This will involve improvements to the sidewalks and streetscape, especially along 52nd Street and Lancaster Avenue -- the main streets in their respective neighborhoods. Envisioned are new sidewalks, street trees, landscaping, bus shelters, lighting and various street furnishings and amenities.

#### VII. Proposed Zoning Changes

No changes in the existing zoning are proposed. Housing rehabilitation, a major goal of this plan, is generally allowed under existing zoning. The other projects that are envisioned will require more planning and design work before the appropriate zoning strategies can be determined. Therefore, zoning changes (via. City Council) or use certificates or variances (from the Zoning Board of Adjustment) may be required depending on specific development plans that are ultimately prepared.

#### VIII. Proposed Street Changes

No changes in street layout are proposed in the Parkside-Lancaster Redevelopment Area.

#### IX. Relocation

This plan recognizes one proposed project where relocation may be required: the proposed commercial project at 1573-97 North 52nd Street, south of Jefferson Street. There are six occupied buildings where owners or tenants may be relocated should this project concept move forward. All relocation will be accomplished in accordance with the terms and conditions of the federal Uniform Relocation Act.

#### XI. Estimated Costs of Redevelopment

The initial project to be advanced under this Redevelopment Area Plan is the acquisition and rehabilitation of 13 scattered vacant houses. The total project cost is estimated at \$1,403,000.

The cost of the other potential redevelopment projects will be determined at a later time. These proposals are conceptual, the sponsors have not prepared specific plans, and the projects are very much subject to change at this time.

XII. Proposed Standards and Controls

Standards and controls for uses, density, land coverage, building area, parking and off-street loading will be established by the zoning code regulations. All impacts of redevelopment on the surrounding residential community will be minimized through development controls regulating site design, building materials and landscaping. These controls will be established by the Redevelopment Authority, and reviewed and approved by the City Planning Commission.

The Pennsylvania Urban Redevelopment Law of 1945, as amended, and the United States Housing Act of 1949, as amended, regulate Redevelopment and Urban Renewal in the City of Philadelphia.

Redevelopment in the Parkside-Lancaster Redevelopment Area will be in conformity with the provisions of this Redevelopment Area Plan. It will be in accord with the requirements of any Urban Renewal Plan prepared by the Redevelopment Authority of the City of Philadelphia for this area, and will comply with the Code of General Ordinances of the City of Philadelphia. All plans and proposals prepared by the Redevelopment Authority will be subject to the recommendations of the City Planning Commission and the approval of the Council of the City of Philadelphia.

**Amendments to the  
Parkside-Lancaster Redevelopment Area Plan**

Philadelphia City Planning Commission  
October 2003

CITY OF PHILADELPHIA

John F. Street, Mayor

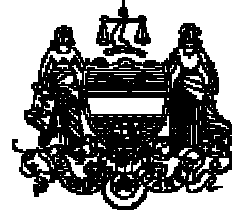

Philadelphia City Planning Commission

Gary Hack, Chairman  
Jeffrey S. Batoff, Vice Chair  
Lynette M. Brown-Sow  
James J. Cuorato  
Janice Davis  
Patrick Eiding  
Phillip R. Goldsmith  
Gloria Levin  
Marcia Moore Makadon

Maxine Griffith, AICP, Executive Director  
Richard L. Lombardo, Deputy Executive Director

**Community Planning Division**

Victoria Mason-Ailey, AICP, Division Director  
Richard Redding, Deputy Division Director

*Report by:*  
Richard Redding

*Contributions by:*  
Cornel Pankey, Community Planner  
Vicki Gatanis, Community Planner  
Bryan Lightner, GIS Specialist, GIS/ Graphics Division

Amendments to the Parkside-Lancaster Redevelopment Area Plan  
**Parkside-Lancaster Redevelopment Area**  
October 2003

The Parkside-Lancaster Redevelopment Area Plan was approved by the Philadelphia City Planning Commission in April 1997. The boundaries of the redevelopment area were established as follows: Parkside Avenue, the SEPTA R-6 right-of-way, 52<sup>nd</sup> Street, Lancaster Avenue, Girard Avenue, and Belmont Avenue. Properties on both sides of Lancaster Avenue were included in the redevelopment area. The major purpose for establishing the Parkside-Lancaster Redevelopment Area was to facilitate housing rehabilitation in the West Parkside neighborhood (vicinity 52<sup>nd</sup> Street & Columbia Avenue).

These Amendments will have the effect of expanding the redevelopment boundary in a southerly direction along 52<sup>nd</sup> Street to Girard Avenue, and east along Girard Avenue to Lancaster Avenue. Additionally, the Amendments will establish land use and site plan guidelines for the expanded area. The initial project requiring redevelopment assistance is a proposal for new infill housing in the 4900 block of Girard Avenue (north side; see photo on page 4). The new housing will be funded through the Empowerment Zone and the Office of Housing and Community Development.

The expanded redevelopment boundaries are consistent with a blight recertification report approved in October 2003 for the area generally bounded by Girard Avenue, 52<sup>nd</sup> Street and Lancaster Avenue. The blight recertification found that 215 vacant properties exist in the study area, along with numerous code violations and several instances of faulty street and lot layout. The blight study concluded that a finding of blight is warranted in this area.

In the Amended Redevelopment Area Plan, the following changes and additions shall take effect:

1. Expand Redevelopment Area Boundaries (see maps on pages 2 and 3)

Expand the boundary south along 52<sup>nd</sup> Street to Girard Avenue, and east along Girard Avenue to Lancaster Avenue. This will include the neighborhood known as Cathedral Park.

2. Existing Land Use (page 3)

In the expanded area, land use is predominantly residential. Fifty-Second Street contains many commercial properties. Warren Street contains a mixture of institutional and industrial properties. There are four institutional properties in the neighborhood, occupied by churches, schools and a club.

3. Proposed Land Use (page 3)

The majority of the Cathedral Park neighborhood is recommended for residential use. Along 52<sup>nd</sup> Street, commercial use is encouraged. Commercial uses are also recommended for Warren Street. Implicit in the Proposed Land Use scheme is the rehabilitation or redevelopment of all vacant properties.

4. Existing and Proposed Zoning (page 4)

No changes in the existing zoning are proposed at this time. Housing revitalization, a major goal of the original redevelopment area plan, is generally allowed under existing zoning. Specific projects that are envisioned will require more planning and design work before the appropriate zoning strategies can be determined. Therefore, zoning changes (via. City Council) or use certificates or variances (from the



Zoning Board of Adjustment) may be required depending on specific development plans that are ultimately prepared.

5. Illustrative Site Plan (page 5)

The Illustrative Site Plan shows existing and proposed buildings in a conceptual manner. It reflects new homes planned for the 4900 block of Girard Avenue, and new commercial uses along 52<sup>nd</sup> Street.

6. Relocation

It is possible that the housing initiative on the 4900 block of Girard Avenue will require some relocation. Preliminary studies indicate that four households may be subject to relocation. The exact number of relocations will be specified in accordance with final development plans to be prepared by a private developer in partnership with the City. All relocation will be accomplished in accordance with the terms and conditions of the federal Uniform Relocation Act.

7. Estimated Costs of Redevelopment

The first project to be advanced will be the revitalization of the 4900 block of Girard Avenue. Total development cost is estimated at \$2.5 million. For additional projects in the future, the Redevelopment Authority will prepare cost estimates as plans are developed.

*Aside from these changes, the provisions of the Parkside-Lancaster Redevelopment Area Plan of April 1997 will remain in effect.*



The Parkside-Lancaster Redevelopment Area is centrally located in West Philadelphia. The original redevelopment boundary is in the red dotted line. The expanded area is shown as a red triangle.



- Residential
- Commercial
- Institution
- Recreation
- Industrial
- Vacant structure
- Vacant lot



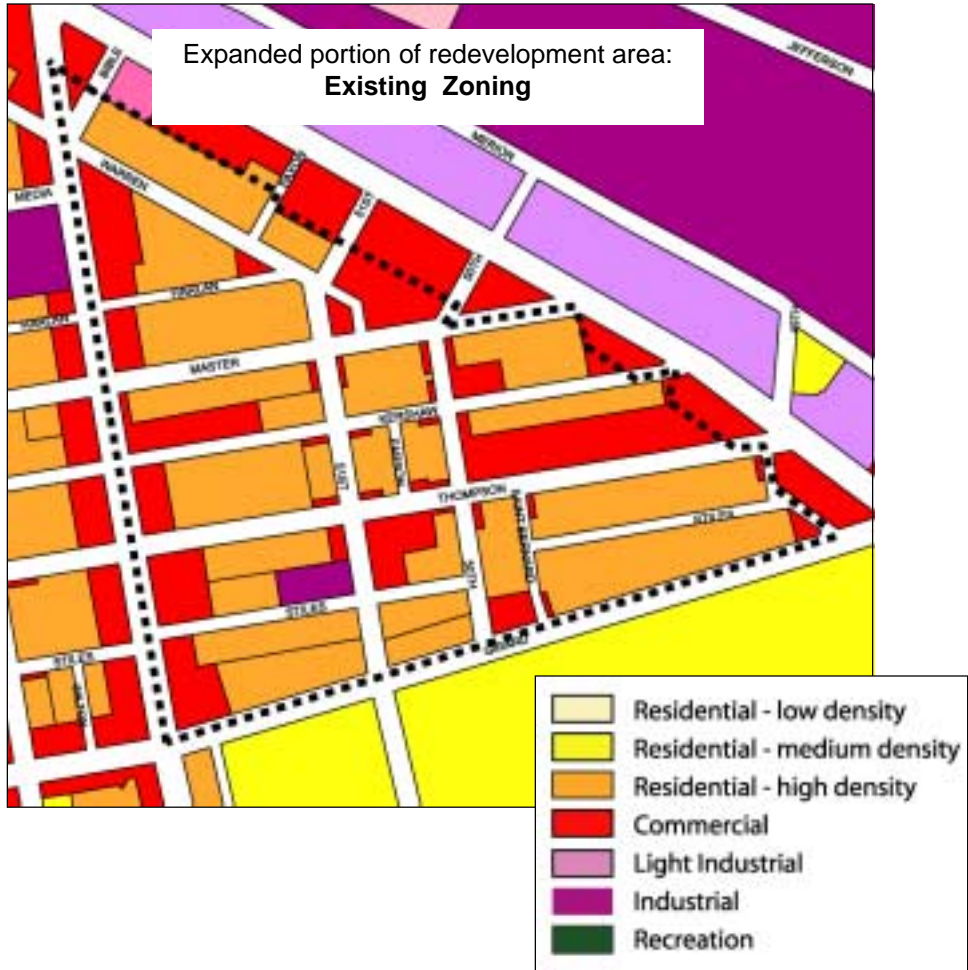

4900 block of Girard Avenue



Above: typical housing in the Cathedral Park neighborhood



Expanded portion of redevelopment area:  
**Illustrative Site Plan**

## Amendments to the Redevelopment Area Plan Parkside - Lancaster Redevelopment Area

PHILADELPHIA CITY PLANNING COMMISSION  
March 2005

The Redevelopment Area Plan for Parkside - Lancaster Redevelopment Area was approved by the Philadelphia City Planning Commission in April 1997. Subsequently the Redevelopment Area was expanded to 52<sup>nd</sup> & Girard in October 2003. The boundaries of the redevelopment area are as follows: Parkside Avenue on the north, Belmont Avenue on the east, Girard Avenue on the south, and 52<sup>nd</sup> Street and the R-6 Railroad on the west.

The following changes are proposed:

### 1. Proposed Land Use

For the area bordered by 52<sup>nd</sup> Street on the west, Columbia (a.k.a. Leidy) Avenue on the north, 50<sup>th</sup> Street (extended) on the east and the R-5 Railroad on the south, the Proposed Land Use will change to "Commercial and Mixed Use;" whereas the previous land use designations for the same area were (1) Residential, (2) Commercial, and (3) Commercial/ Industrial.

### 2. Rehousing of Displaced Families

Some existing properties will require relocation assistance. All relocation will be accomplished in accordance with the terms and conditions of the Pennsylvania Eminent Domain Code.

### 3. Estimated Costs of Redevelopment

For a potential 30-acre site bordered by 52<sup>nd</sup> Street on the west, Columbia (a.k.a. Leidy) Avenue on the north, 50<sup>th</sup> Street (extended) on the east and the R-5 Railroad on the south, a shopping center is proposed with estimated total development cost of \$32 million.

*Aside from these changes, the provisions of the Parkside – Lancaster Redevelopment Area Plan of April 1997, as amended, will remain in effect.*

